



-  Dielectric Grease (92-823506--1)
-  Loctite PST Pipe Sealant (92-809822)



NOTE: APPLY LIQUID NEOPRENE TO ALL EYELET WIRING TERMINAL CONNECTIONS.

Parts List

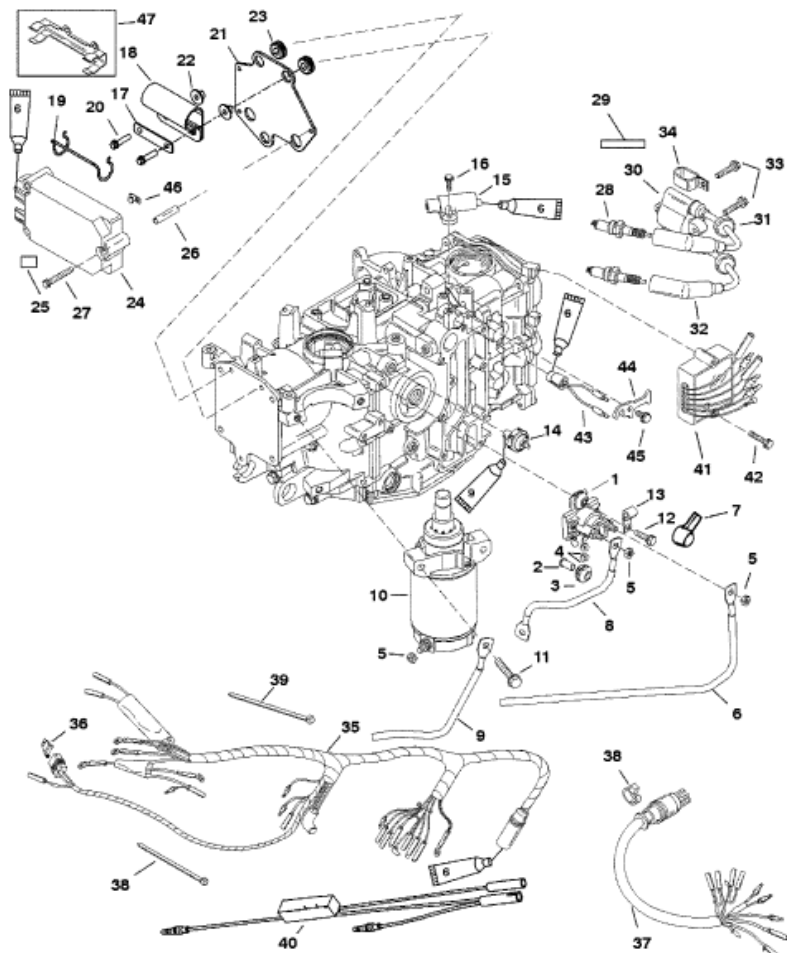
Ref	Class	Part	Description	Qty	Comment	Footnote
1	89	850187A 1	SOLENOID ASSEMBLY	1		
2	23	818968	BUSHING	2		
3	25	818967	GROMMET	2		
4	11	26419	NUT (8-32)	2	(ELECTRIC)	
5	11	94330	NUT (1/4-20)	3		
6	84	88439A 9	BATTERY CABLE (POSTITIVE)	1		
7	85	79695	INSULATOR BOOT	1		
8	84	93388A 7	CABLE	1		
9	84	88439A 4	BATTERY CABLE (NEGATIVE)	1		
10	50	830308	STARTER MOTOR (SEE BREAKD	1		
11	10	40011153	SCREW (M8 X 45)	3	(ELECTRIC)	
11	10	40011149	SCREW (M8 X 25)	1	(MANUAL)	
12	10	826844 25	SCREW (M6 X 25)	2	(ELECTRIC)	
12	10	824832 4	SCREW (M6 X 16)	1	(MANUAL)	
13	54	54457	J CLIP	1		
14	87	828040	PRESSURE SWITCH	1		2
15		828358	SENSOR-CRANK POSITION	1		
16	10	40011107	SCREW (M5 X 16)	2		
17		856040	BRACKET	1	(ELECTRIC - DESIGN II)	
18		856039	MOUNT	1	(ELECTRIC - DESIGN II)	
19		92753	RETAINER	1	(ELECTRIC - DESIGN II)	
20	10	821291 25	SCREW (M6 X 25)	3		
21		855670	PLATE	1		
22	23	822003	BUSHING	3		
23	25	834985	GROMMET	3		
24		856482 2	ECM	1		1
25		NSS	DECAL-CAUTION START IN GEAR	1		6
26	23	853920 1	BUSHING	3		
27	10	821291 45	SCREW (M6 X 45)	3		
28	33	827858	SPARK PLUG (NGK DPR6EA-9)	2		
29		NSS	DECAL-COIL IDENTIFICATION	1		6
30	339	825101A 2	IGNITION COIL ASSEMBLY	1	(Includes Leads and Boots)	
31	25	82069M	GROMMET	2		
32	84	825102A 1	HI-TENSION BOOT	2		
33	10	826844 30	SCREW (M6 X 30)	2		
34	54	65292	J CLIP	1		
35	84	850167A 2	ENGINE WIRING HARNESS	1	(MANUAL)	
35	84	830279A 4	ENGINE WIRING HARNESS	1	(ELECTRIC)	
36	88	812619	FUSE (SFE 20 AMP)	1		
37	84	855225A 2	HARNESS-AUXILIARY	1		
38	54	816211	STA STRAP	AP		10